



Webbs
Helping people move since 1994

Brindley Bank Road | Rugeley | WS15 2EY
Offers In Excess Of £360,000

 **Webbs**
estate agents

Summary

*****OPEN TO OFFERS*****WEBBS ESTATE AGENTS have pleasure in offering this deceptively spacious three-bedroom detached bungalow is situated in a highly sought-after location on Brindley Bank Road, enjoying a prime position on the banks of the Trent & Mersey Canal. Offering generous accommodation throughout, this property simply must be viewed to be fully appreciated! Briefly comprising: Entrance Porch, Hallway, Lounge, Dining Room, Kitchen, Cloakroom, Three Bedrooms, Bathroom, Large Conservatory, Good Size Rear Garden with Access to Trent & Mersey Canal, Driveway and a Single Garage.

Key Features

- NO UPWARD CHAIN
- SOUGHT AFTER LOCATION
- CLOSE TO AMENITIES
- SINGLE GARAGE
- THREE BEDROOM
- ON THE BANKS OF THE TRENT & MERSEY CANAL
- LARGE CONSERVATORY
- DRIVEWAY

Rooms and Dimensions

Identification Checks (R)

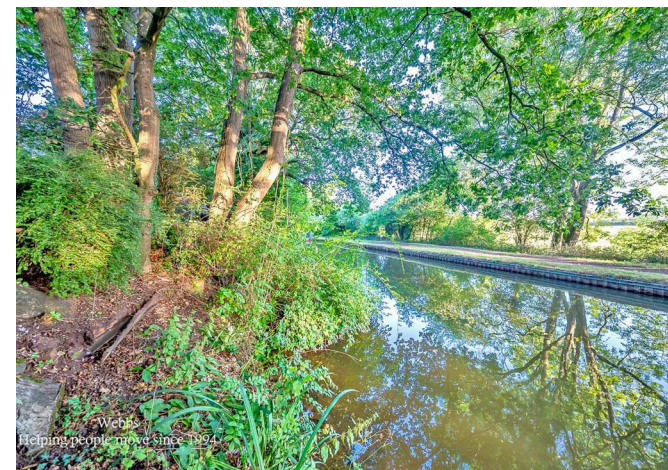



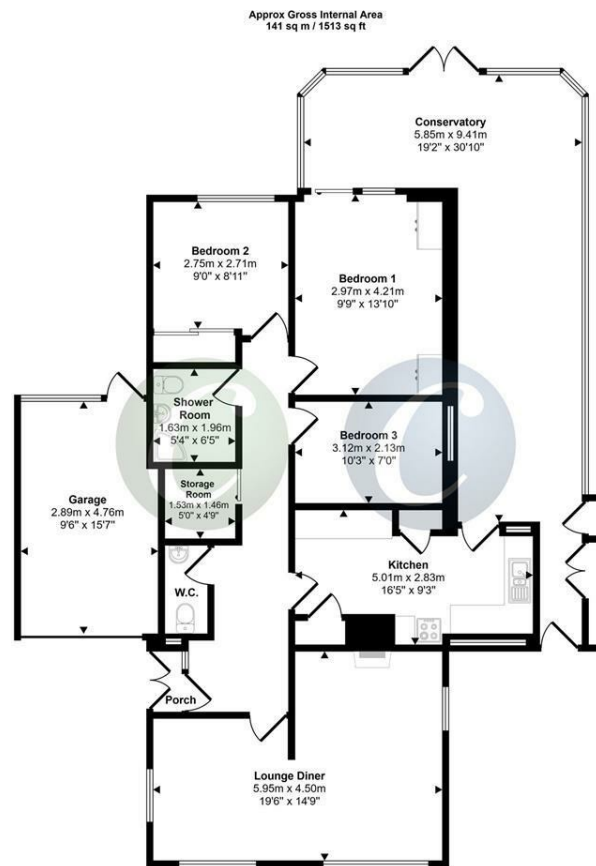

Floorplan

This floorplan is only for illustrative purposes and is not to scale. Measurements of rooms, doors, windows, and any items are approximate and no responsibility is taken for any error, omission or mis-statement. Icons of items such as bathroom suites are representations only and may not look like the real items. Made with Made Snappy 360.

Webbs Estate Agents - endeavour to maintain accurate depictions of properties in Virtual Tours, Floor Plans and descriptions, however, these are intended only as a guide and purchasers must satisfy themselves by personal inspection.

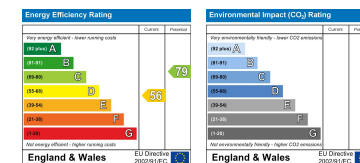

Globe House Upper Brook Street, Rugeley, Staffordshire, WS15 2DN

Tel: 01889 583377 | Email: rugeley@webbsea.co.uk | www.webbestateagents.co.uk

Webbs
estate agents